

## Glastür-Montagesets PED 200 / PED 210 Glass door mounting sets PED 200 / PED 210

gilt für Artikel:  
applies to Cat. No.:  
909.09.900-906

Montagevarianten Mounting options							
	notwendige Glassbearbeitungen Required glass preparation	3.1, 4	1.1, 2, 3.1, 3.2, 4	1.1, 2, 3.1, 4	1.1,1.2, 2, 3.1, 4	1.1,1.2, 2, 3.1, 3.2, 4	1.1, 1.2, 2, 3.1, 3.2, 4
A	für Glastür-Montage Blindrosetten For glass door assembly Blank escutcheons	X	X	X	X	X	XX
B	Für Glastür-Montage DIN links For glass door assembly DIN left	X	X	X	X	X	XX
C	Für Glastür-Montage DIN rechts For glass door assembly DIN right	X	X	X	X	X	XX
D	Für Glastür-Montage Treibriegelstange For glass door assembly shoot bolt			O	O	O	O
E	Für Glastür-Montage Verriegelung mitte For glass door assembly centre lock		O			O	O
F	Für Glastür-Montage Verriegelung oben For glass door assembly top lock				O	O	O
G	Für Treibriegelstange For shoot bolt			O	O	O	O

X = es wird 1 Set aus A, B oder C benötigt  
XX = es werden 2 Sets aus A, B oder C benötigt  
O = es wird jeweils 1 Set benötigt.

X = 1 set from A, B or C is required  
XX = 2 sets from A, B or C are required  
O = 1 set each is required

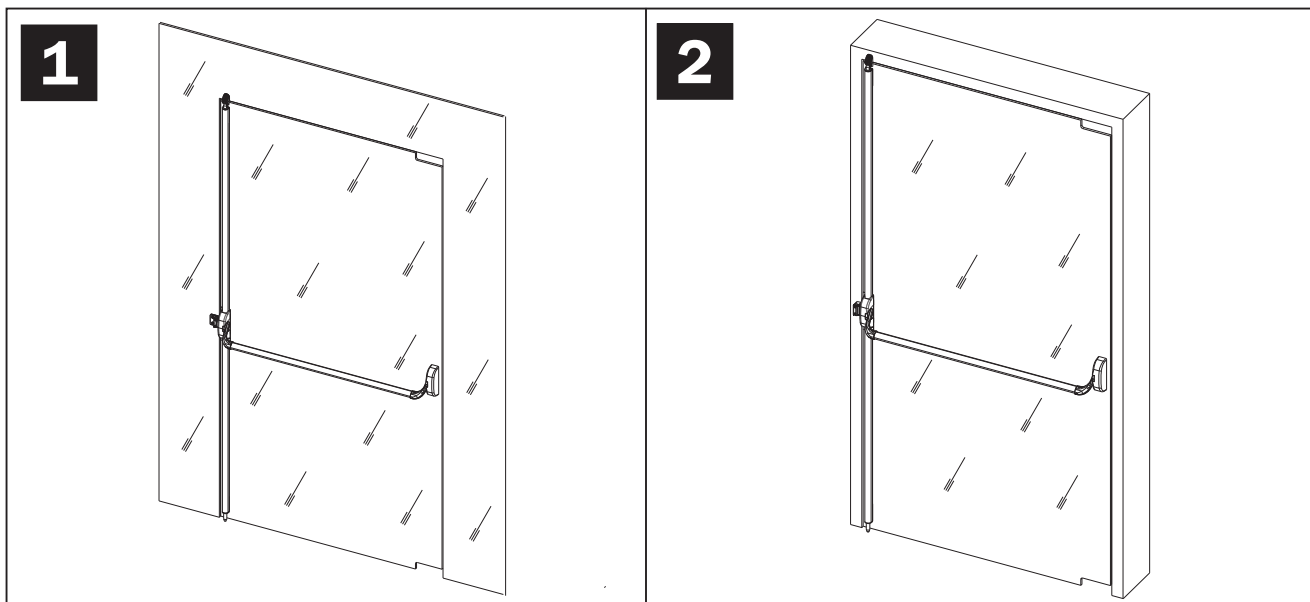

1

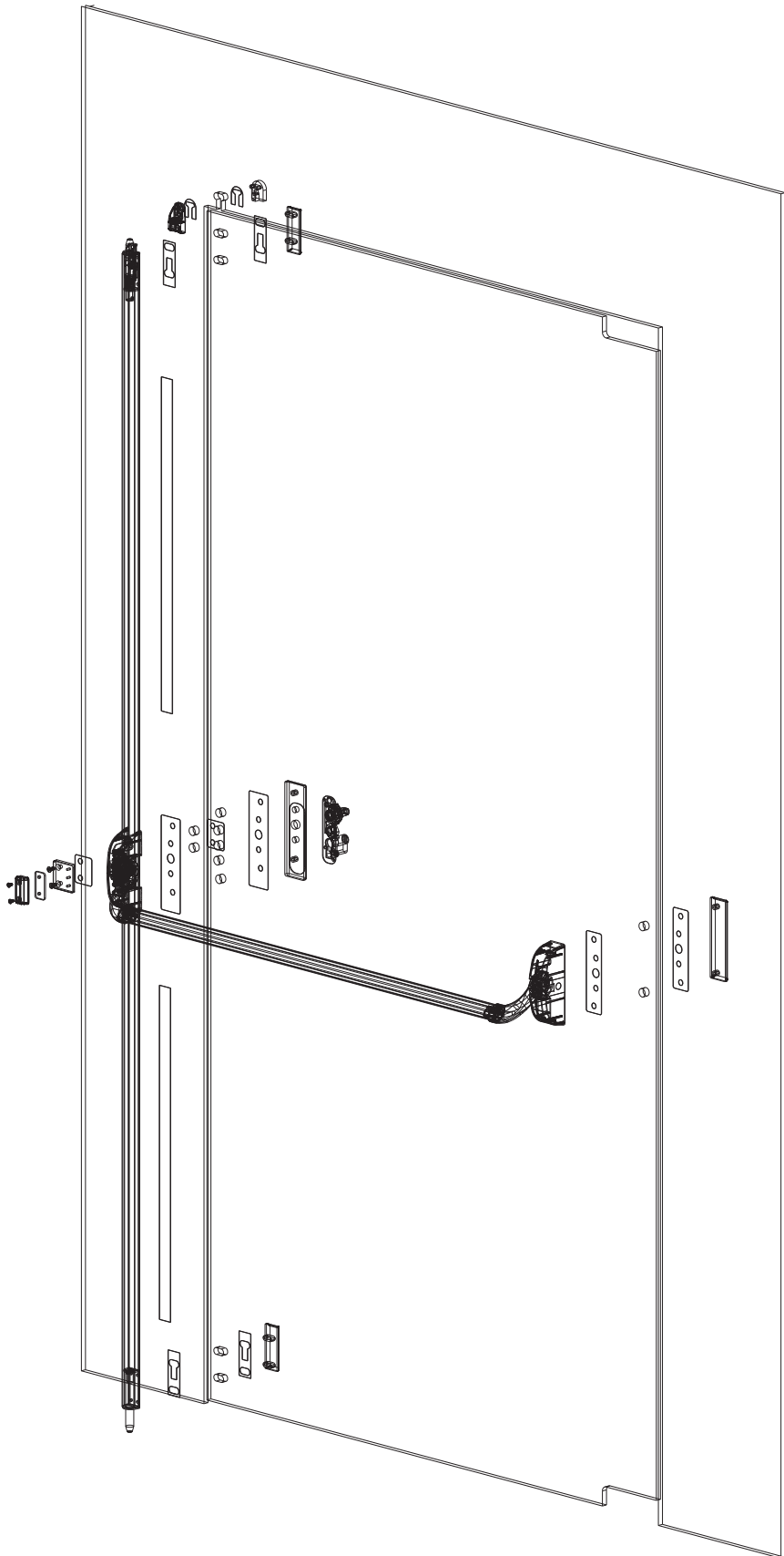

## 1a

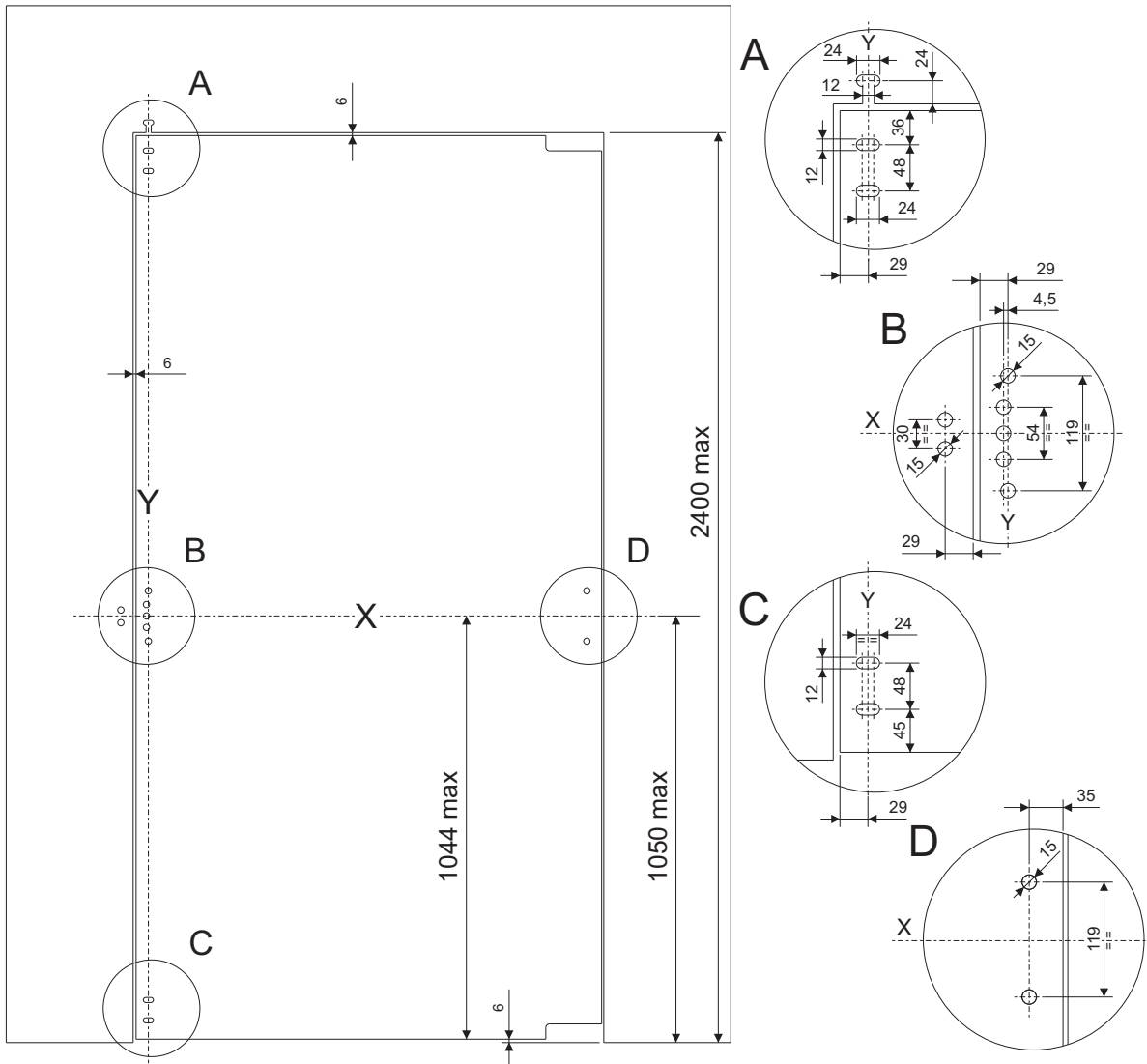

2

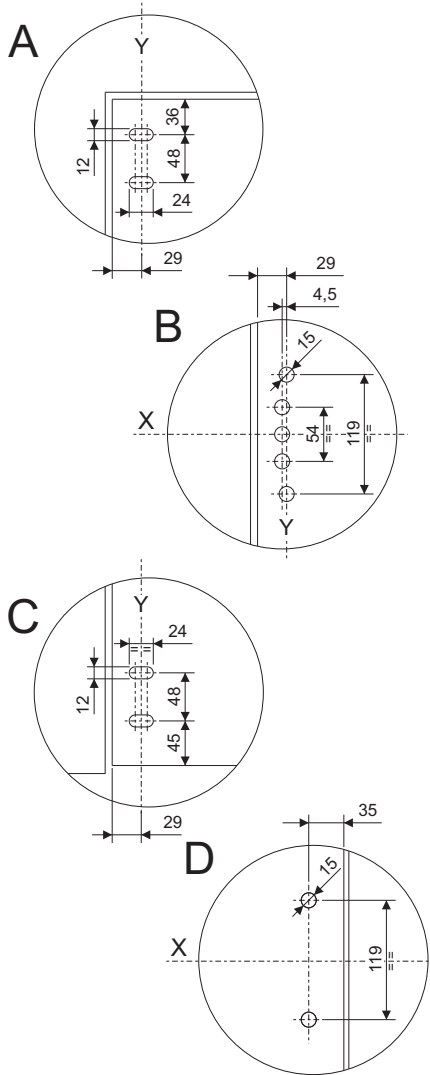
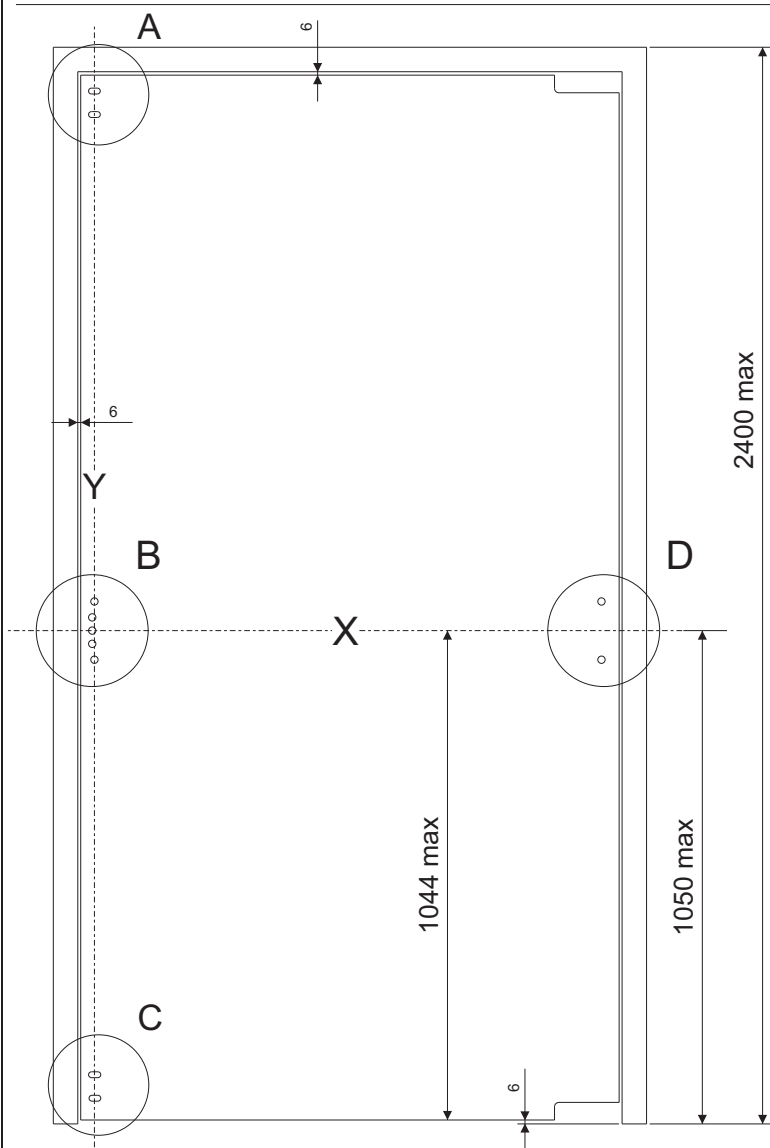
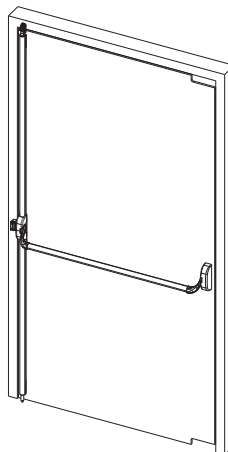
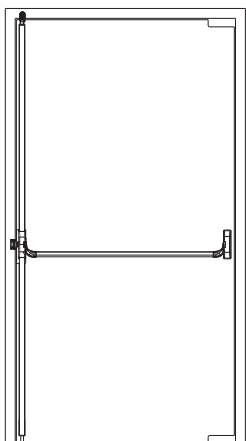

## 3

